

Absolute encoders - modular bus covers

Solid shaft with clamping flange, stainless steel housing

Optical multiturn encoders 13 bit ST / 16 bit MT

CANopen / DeviceNet / EtherNet-IP / Profibus / PROFINET

GFMMW



GFMMW with modular bus cover

Features

- Encoder multiturn / bus cover
- Stainless steel design V4A
- Optical sensing method
- Resolution: singleturn 13 bit, multiturn 16 bit
- Clamping flange
- CANopen/DeviceNet/EtherNet-IP/Profibus-DP/PROFINET
- Material: stainless steel 1.4404
- Maximum resistant against magnetic fields

Technical data - electrical ratings

Voltage supply	10...30 VDC
Reverse polarity protection	Yes
Consumption w/o load	≤100 mA (24 VDC)
Initializing time typ.	250 ms after power on
Interfaces	CANopen®, DeviceNet, EtherNet/IP, Profibus-DPV0, PROFINET
Function	Multiturn
Device adress	Rotary switch in bus cover (type-specific)
Steps per revolution	≤8192 / 13 bit
Number of revolutions	≤65536 / 16 bit
Absolute accuracy	±0.025 °
Sensing method	Optical
Code	Binary
Code sequence	CW/CCW programmable
Interference immunity	DIN EN 61000-6-2
Emitted interference	DIN EN 61000-6-4
Programmable parameters	Steps per revolution Number of revolutions Preset Scaling Rotating direction
Diagnostic functions	Position or parameter error Multiturn sensing
Approval	UL approval / E63076

Technical data - mechanical design

Size (flange)	ø58 mm
Shaft type	ø10 mm solid shaft (clamping flange)
Flange	Clamping flange
Protection DIN EN 60529	IP 67
Operating speed	≤10000 rpm (mechanical) ≤6000 rpm (electric)
Starting acceleration	≤1000 U/s ²
Starting torque	≤0.03 Nm (+25 °C, IP 67)
Rotor moment of inertia	20 gcm ²
Admitted shaft load	≤20 N axial ≤40 N radial
Materials	Housing: stainless steel 1.4404 Flange: stainless steel 1.4404 Bus cover: stainless steel 1.4404
Operating temperature	-25...+85 °C -40...+85 °C (optional)
Relative humidity	95 % non-condensing
Resistance	DIN EN 60068-2-6 Vibration 10 g, 16-2000 Hz DIN EN 60068-2-27 Shock 200 g, 6 ms
Weight approx.	900 g
Connection	Bus cover

Absolute encoders - modular bus covers

Solid shaft with clamping flange, stainless steel housing

Optical multiturn encoders 13 bit ST / 16 bit MT

CANopen / DeviceNet / EtherNet-IP / Profibus / PROFINET

GFMMW

Part number

GFMMW. **A** **20**

<p>Flange / Solid shaft A Clamping flange / $\varnothing 10$ mm, IP 67</p>	<p>Interface</p> <p>3P32 Profibus-DPV0 / cable gland</p> <p>5P32 CANopen® / cable gland</p> <p>8P22 DeviceNet / cable gland</p> <p>3EA2 PROFINET / connector M12</p> <p>8EA2 EtherNet/IP / connector M12</p>
---	--

Accessories

Mounting accessories

11191971 Spring washer coupling - stainless steel
D1=10 / D2=10 (Z 121.G03)

Programming accessories

10146710 CD with describing files & manuals
(Z 150.022)

CD with file descriptions is not included in the delivery. You may order them on CD as accessory.

Dimensions

GFMMW - CANopen, Profibus-DP

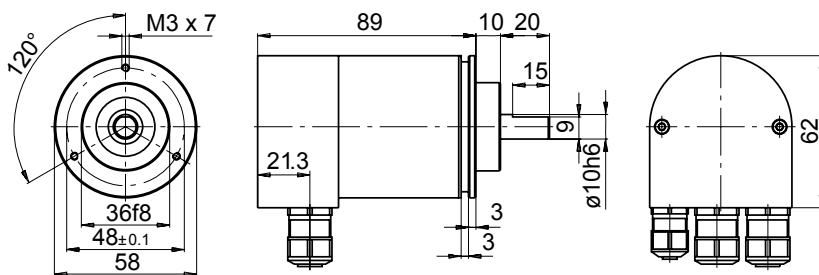

GFMMW - DeviceNet

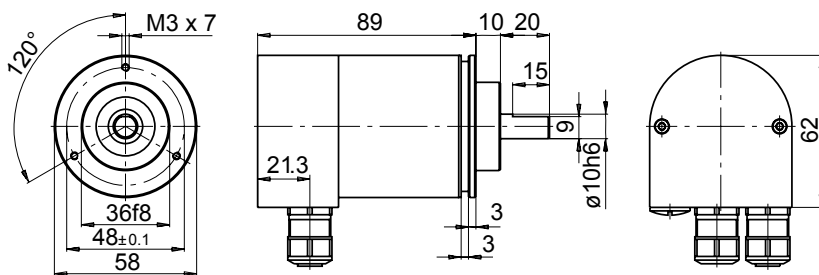

GFMMW - PROFINET, EtherNet-IP

